

BANNERUP[®]

A Family of Dependable Displays



Assembly instruction
Plus model

Change of printed banner



Roll the old banner out of the cassette.



Insert the locking pin.



Slide the banner out.

Mount two **new** rails (one Quick-change kit) on to the new banner.

Follow "Mounting of printed banner" on the previous page.

TENSION ADJUSTMENT

All cassettes are pretensioned before delivery.



If adjustment is needed, hold the cassette firmly in place then depress and turn the adjusting screw clockwise to increase the tension (the tension mechanism adjusts in halfturn increments). Slowly release pressure on the screw turning slightly counter-clockwise and allow it to again lock in place. If tension has been lost completely, we recommend 20-25 full clockwise turns.

Mounting of printed banner

Top rail

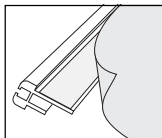

Mount the top rail on the **reverse side** of the banner, parallel to the upper edge.

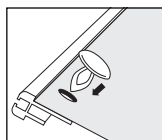

Maximum security.

Carefully make holes in the banner to align with the holes in the rail. Insert the plastic push pins provided.

Bottom rail

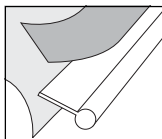

For extra security, mount a tape over the rail and banner

Mount the bottom rail on the **reverse side** of the banner.

1



IMPORTANT !

Roll **laminated** banners **print-side out**.
Roll **non-laminated** banners **print-side in**.

Slide the bottom rail into the cassette.



Hold the banner and remove the locking pin.

Let the banner **slowly** roll into the cassette.



IMPORTANT

Always **roll the banner slowly** in and out of the cassette, and be sure to **centralise** the feed in to avoid edge damage to the graphic.

This is particularly important for un laminated (unprotected) banners. You may also need to steady the cassette, with a foot, as the recoil is quite strong.

Production of printed banner

The banner material can be vinyl, fabric, double sided laminated paper etc.

Laminated banner material should be soft (supple) enough to roll easily around the cassette roller at normal spring tension. 0,45 mm (0.018") is the maximum thickness to be used.

Banner dimensions

Visible part of banner material:

206 cm (81")

With extension pole, item 89255 = 225 cm (88").

With extension pole, item 89256 = 244 cm (96").

With extension pole, item 89257 = 294 cm (116").

Printed length of banner:

210 cm (83")

With extension pole, 19 cm = 229 cm (90").

With extension pole, 38 cm = 248 cm (97").

With extension pole, 89 cm = 298 cm (117").

Min. extra banner material (unprinted): 30 cm (12")

Total length of banner material:

240 cm (95")

With extension pole, 19 cm = 259 cm (102").

With extension pole, 38 cm = 278 cm (109").

With extension pole, 89 cm = 328 cm (129").

Width, max (do not exceed): 88 cm (34.65")

Full height, 3 pole sections

Visible banner height:

206 cm (81")

With extension pole, item 89255 = 225 cm (88").

With extension pole, item 89256 = 244 cm (96").

With extension pole, item 89257 = 294 cm (116").

Total banner length:

240 cm (95")

Mid-height, 2 pole sections

Visible banner height:

140 cm (55")

Total banner length:

174 cm (69")

Lowest height, 1 pole section

Visible banner height:

73 cm (29")

Total banner length:

107 cm (42")

Additional print: 4 cm (1.5")

Extra banner material (unprinted): 30 cm (12")

Facts

	88 (3 ft.)	100 (40 in.)	120 (4 ft.)	150 (5 ft.)
Banner width	88 cm (34.65")	100 cm (39.35")	120 cm (47.25")	150 cm (59.00")
Full height w/ cassette	212 cm (83.5")	212 cm (83.5")	212 cm (83.5")	212 cm (83.5")
Visible banner height	206 cm (81")	206 cm (81")	206 cm (81")	206 cm (81")
Weight (excl. banner)	5,4 kg (11.8 lbs)	5,8 kg (12.7 lbs)	7,3 kg (16.0 lbs)	8,5 kg (18.7 lbs)
Cassette dimension	14x11x89 cm (5.5"d x 4.5"h x 35"w)	14x11x101 cm (5.5"d x 4.5"h x 40"w)	14x11x121 cm (5.5"d x 4.5"h x 48"w)	14x11x151 cm (5.5"d x 4.5"h x 59.4"w)
Item No.	81115	81116	81117	81118

Accessories



Extension pole

- for visible height of 225 cm (88"), item no. 89255
- for visible height of 244 cm (96"), item no. 89256
- for visible height of 294 cm (116"), item no. 89257

Quick-change banner mounting kit

1 pair of banner rails (top and bottom) with mounting tape and 6 plastic push pins. (1 kit included in 81115/81116/81117/81118).

88 (3 ft.)	100 (40 in.)	120 (4 ft.)	150 (5 ft.)
Item no. 81020	Item no. 81030	Item no. 81040	Item no. 81050

For other accessories, such as carrying cases, spotlights etc., see our general price list.



**Please find more
"Locking pins" under the feet!**

Application Techniques

- To obtain optimum adhesion, the bonding surfaces must be well unified, clean and dry. Typical surface cleaning solvents are isopropyl alcohol/water mixture (rubbing alcohol) or heptane.
Note: Be sure to follow solvent manufacturer's precautions and directions for use when using solvents. (Step A and B).
- Bond strength is dependent upon the amount of adhesive-to-surface contact developed. Firm application pressure develops better adhesive contact and helps improve bond strength (Step C).
- After application, the bond strength will increase as the adhesive flows onto the surface. At room temperature approximately 50% of the ultimate strength will be achieved after 20 minutes, 90% after 24 hours and 100% after 72 hours. In some cases bond strength can be increased and ultimate bond strength can be achieved more quickly by exposure of the bond to elevated temperatures (e.g. 150°F /66°C) for 1 hour). This provides better adhesive onto the substrates.



Step A:
Solvent wipe



Step B:
Wipe dry



Step C:
Firm pressure onto surface

Assembly instruction

88 cm (3 ft.) – 100 cm (40 in.)



Take out the BannerUp from the bag.



For increased stability pull out the four support legs on the cassette.



Take two of the pole sections (start with the untapered) and mount these on the cassette.

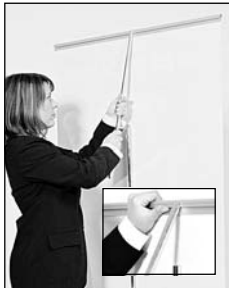

Pull the banner halfway out of the cassette. Hook the third pole section to the top rail of the banner. Push the banner up to full height to complete pole assembly.

120 cm (4 ft.) – 150 cm (5 ft.)



For increased stability pull out the four support legs on the cassette.



Mount all six pole sections on the cassette (start with the untapered).



Pull the banner up to full height and hook the poles to the top rail of the banner.

Never pull out the "Locking pin" until a banner is loaded into the cassette!

This will immediately release the spring tension and can damage the mechanism.